



Dover Roller Shutters
 295 Commerce Way
 Upper Sandusky OH 43351
 Phone: 419-294-3373 Fax: 419-294-3329

Opening Size Up To 120" wide Up To 90" high

NYLOY30 EXTRUDED ALUMINUM SHUTTER

Specification:

Slat:

1 1/8" high x .46 thick x .045 double walled extruded aluminum. Aluminum alloy and temper of 6063-T6

End Locks:

Interlocking and mechanically fastened nylon end locks

Side Guide (track):

Extruded aluminum guides with optional fastening locations

Bottom Rail:

Extruded aluminum section, 3" high fitted with 1 5/8" Integrated finger Rail

Operation:

Rolling spring counter balanced, Hand operated or electric, and sliding gravity feed.

Locking:

Stainless steel bar lock, Optional; flush locks, key operated & T handles, locking or non-locking.

Rolling operating components:

Roller: 2 1/2 -3" lightweight aluminum tube encasing helical coil spring.

Brackets:

Fabricate from mild steel to suit applications

Sliding operating components:

Guides incorporating molded nylon corner segments.

Roll Size Chart - 2 1/2" Roller

OPENING HEIGHT	A	B	C	D
20	6 1/2	3 1/4	6 1/2	4 1/2
30	6 3/4	3 3/4	6 1/2	5 1/2
40	7	4	7 1/2	6 7/8
50	7 1/4	4 1/4	7 7/8	7 3/8
60	7 1/2	4 1/2	8 3/8	7 3/8
70	7 3/4	4 3/4	8 5/8	7 5/8
80	8	5	9 1/4	9 1/8
90	8 1/4	5 1/4	9 5/8	9 5/8

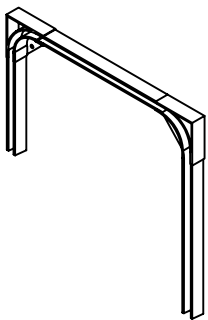
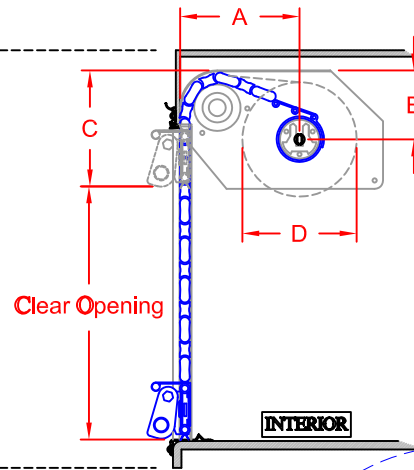
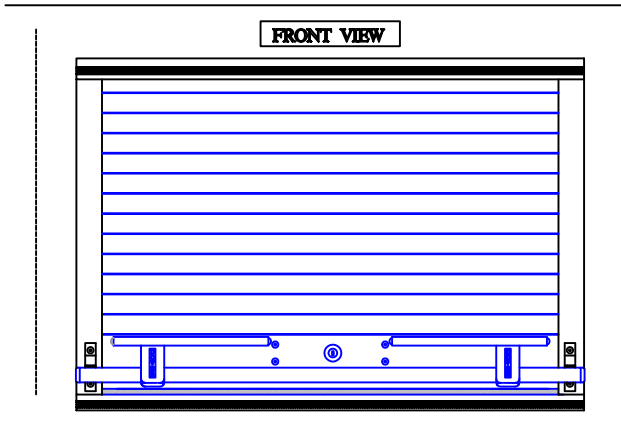
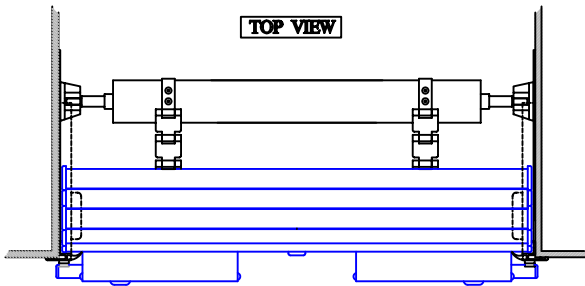

SLIDING SHUTTER - Gravity Feed

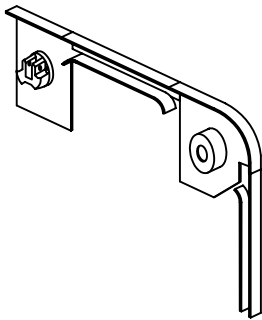

REAR ROLLER ASSISTITED

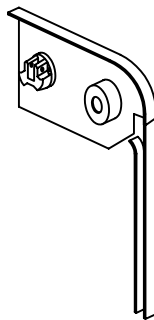

FRONT ROLLER ASSISTITED

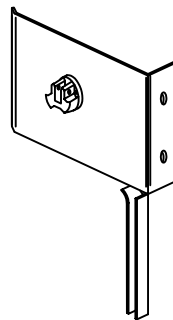

ROLLER ONLY- Behind Wall Mount

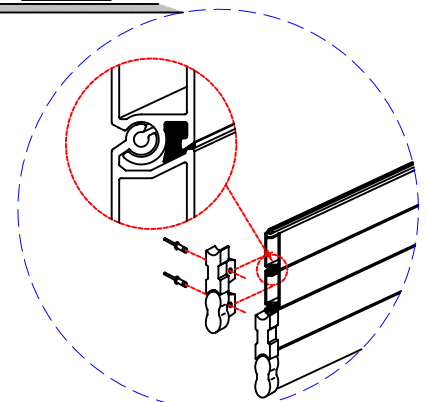

INTERGRATED RUBBER JOINT SEAL
 INTERLOCKING BALL AND SOCKET SLATS
 MECHANICALLY FASTENED END LOCKS

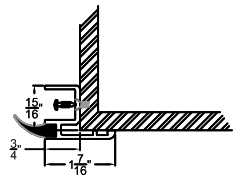

ONE PIECE GUIDE

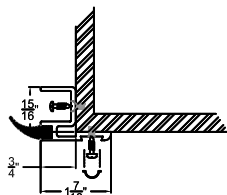

ONE PIECE GUIDE With Groove

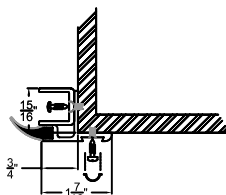

STAINLESS STEEL TRACK WITH T-TRIM

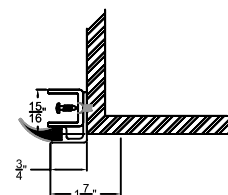

STAINLESS STEEL TRACK WITH L-TRIM

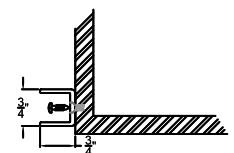

STAINLESS STEEL TRACK